

THE RESOURCES AGENCY OF CALIFORNIA
California Department of Fish and Game

STREAM SURVEY

File form No. _____
Date: March 6, 1968

NAME: Spanish Creek **COUNTY:** Mendocino

STREAM SECTION: entire **FROM:** Headwaters **TO:** mouth **LENGTH:** 2 miles

TRIBUTARY TO: Brush Creek **TWP:** 13N **R:** 16W **SEC:** 19

OTHER NAMES: Unknown **RIVER SYSTEM:** Brush

SOURCES OF DATA: Personal observation

EXTENT OF OBSERVATION
Include: Name of Surveyor, Date, Etc.
LOCATION
RELATION TO OTHER WATERS
GENERAL DESCRIPTION
Watershed
Immediate Drainage Basin
Altitude (Range)
Gradient
Width
Depth
Flow (Range)
Velocity
Bottom
Spawning Areas
Pools
Shelter
Barriers
Diversions
Temperatures
Food
Aquatic Plants
Winter Conditions
Pollution
Springs
FISHES PRESENT AND SUCCESS
OTHER VERTEBRATES
FISHING INTENSITY
OTHER RECREATIONAL USE
ACCESSIBILITY
OWNERSHIP
POSTED OR OPEN
IMPROVEMENTS
PAST STOCKING
GENERAL ESTIMATE
RECOMMENDED MANAGEMENT
SKETCH MAP
REFERENCES AND MAPS

EXTENT OF OBSERVATION - Walked from mouth to headwaters by Larry M. Johnson and Gary Miller on September 8, 1967.

LOCATION - Stream heads approximately one mile north and 3 miles east of Manchester. The mouth is ¼ mile north and ½ mile east of Manchester.

RELATION TO OTHER WATERS - This stream is minor tributary to Brush Creek. It supplies a small amount of cold water and limited spawning and nursery area for SH-RT.

GENERAL DESCRIPTION
Watershed and Immediate Drainage Basin - Stream runs through a narrow V-shaped canyon in a westerly direction. Soil in the basin is rich humus and the streamside vegetation is dense. Many ferns, brush plants, trees (redwood, alder, Douglas fir).

Altitude - Heads at 1,000 ft. drops to 100 ft. at its mouth.

Gradient - Averages 450 ft. drop per mile. However, the stream only drops 100 ft. in the first mile upstream from mouth.

Width - Average 3 ft., range 6"-6 ft.

Depth - Average 2", range ½"-8".

Flow - .75 c.f.s. at mouth

Velocity - Rapid throughout

Bottom - 70% cemented gravel, 15% boulders and rubble, 15% loose gravel.

Spawning areas - Limited to a few scattered areas.

Pools - Very limited pool development, pools only make up 5% of stream area.

Shelter - Good, many undercut banks.

Barriers - None seen

Diversions - None seen

Temperatures - At mouth, air 62°F, water 56°F, temperatures taken at 1100 on September 8, 1967.

Food - Abundant approximately 30 organisms per sq. ft. of rock area (caddis worm, mayfly, -larvae).

Aquatic plants - Small amount of green algae, and some horsetail observed.

Winter conditions - Judging by debris and walls of streambed it appears as if stream is about five times as large in the winter runoff.

Pollution - None seen

Springs - None seen

FISHES PRESENT AND SUCCESS - SH-RT fry observed (20 per 100 ft.) sizes not exceeding 5", average 2". Fish appeared to be in good success and condition.

OTHER VERTEBRATES - Frogs

FISHING INTENSITY - Unknown

OTHER RECREATIONAL USE - Unknown

ACCESSIBILITY - Stream is accessible from Highway 1 via county road. This road is the first road north of Brush Creek bridge that heads east. The stream crosses the county road approximately $\frac{3}{4}$ of a mile from Highway 1.

OWNERSHIP - Private ranch

POSTED OR OPEN - Posted

IMPROVEMENTS - None observed. None needed.

PAST STOCKING - Unknown

GENERAL ESTIMATE - This stream is of very limited fisheries value due to its small flow and lack of pool and spawning area.

RECOMMENDED MANAGEMENT - None

SKETCH MAP - Attached

REFERENCES AND MAPS - USGS Quad. Point Arena - 1960.

Gerald Holman
Assistant Fishery Biologist
Region 3

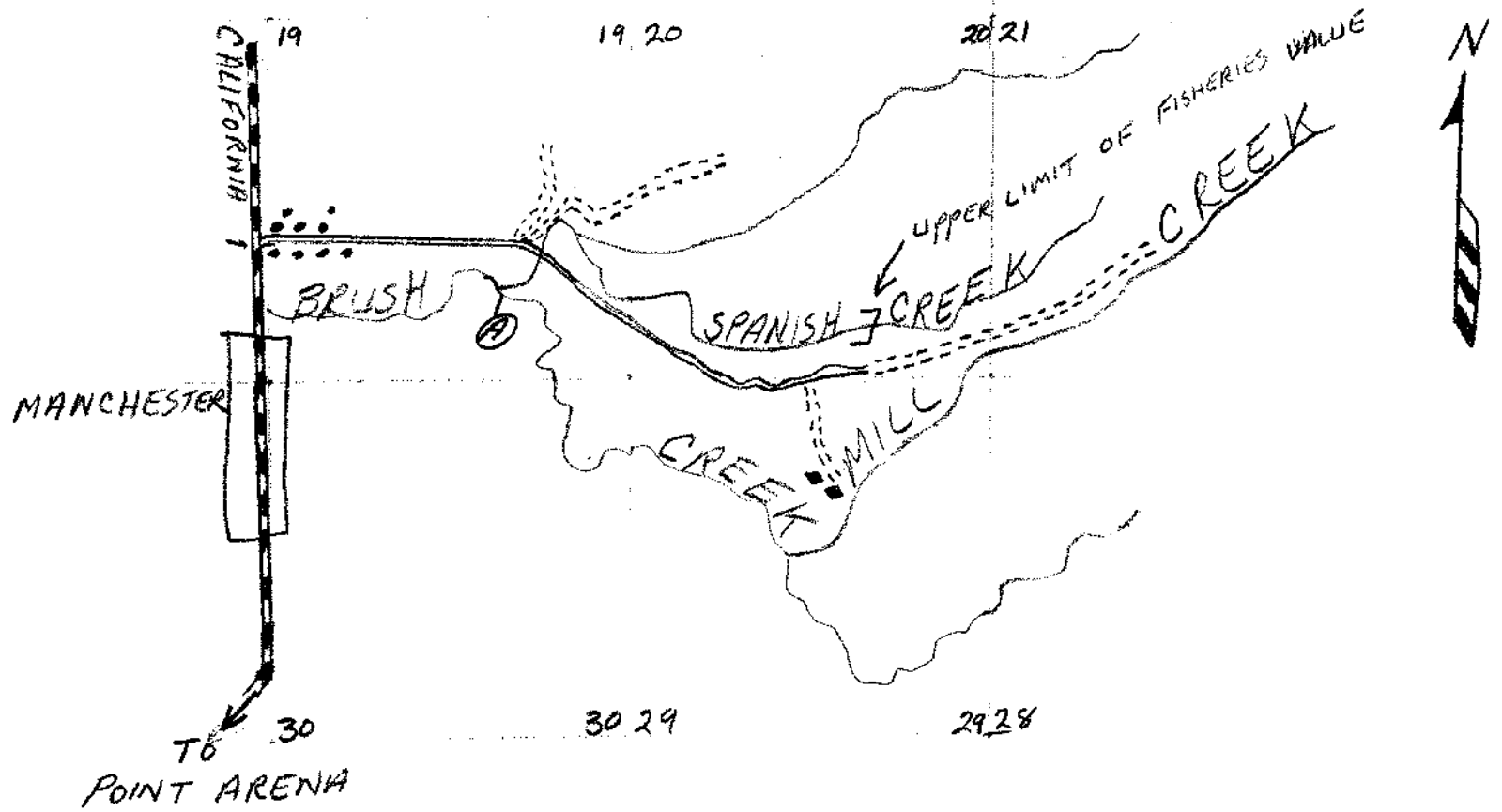

SPANISH CREEK
 TWP. 13N R. 16W SEC. 19

4:4